

P E B

**PRE-ENGINEERING
BUILDINGS**

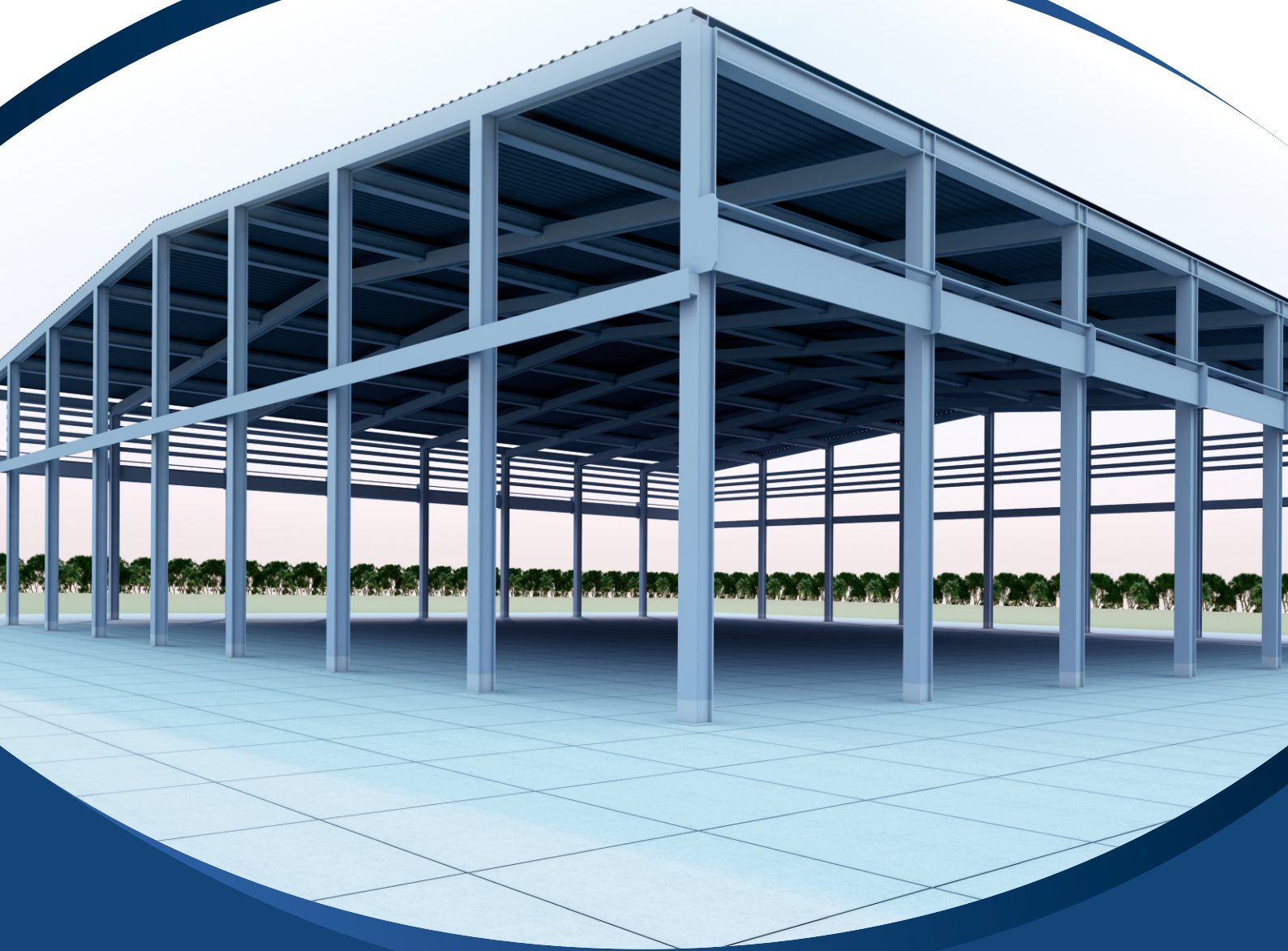

Engineering Strength,
BUILDING SUCCESS

INTRODUCTION TO SOLUTECH INFRASTRUCTURE

> **SOLUTECH INFRASTRUCTURE PVT LTD** is a leading player in the construction and infrastructure industry, specializing in the design, fabrication and installation of Pre-Engineered Building (PEB). We pride ourselves on offering innovative, efficient and cost-effective solutions for various sectors, including industrial, commercial and residential projects.

Our expertise lies in providing fully integrated infrastructure services, where we ensure the highest standards of quality and precision in every phase of the project—right from conceptualization to final execution. With a focus on sustainability, energy efficiency and cutting-edge technology, we are dedicated to delivering durable and reliable structures that stand the test of time.

We solutech infrastructure are also well known for our

- > More than 10 to 10,000 Tons of annual structural fabrication capacity.
- > More than 12,000 Tons of Pre Engineered Buildings manufactured.
- > More than 80,000 Sq. ft. of manufacturing facility area.
- > More than 40,00,000 Sq. ft. Area covered by Pre Engineered Building.

SOLUTECH INFRASTRUCTURE - Beyond PEB

- > **SOLUTECH INFRASTRUCTURE PVT LTD** is at the forefront of innovation in the Pre-Engineered Buildings industry, offering advanced, cost-effective and sustainable infrastructure solutions. We specialize in end-to-end services, from design to installation, delivering high-quality, durable, and energy-efficient structures across various sectors.
 - > Our commitment to sustainability, safety and innovation drives us to create buildings that reduce construction time, environmental impact and operational costs. By integrating cutting-edge technology and industry-leading practices, we ensure each project meets international standards while exceeding client expectations.
 - > At Solutech, we're shaping the future of construction with smarter, scalable and eco-friendly building solutions, paving the way for a more efficient and sustainable infrastructure industry.
- 

COMPANY PROFILE

OUR VISION

- > To be a global leader in providing innovative, sustainable & high-quality Pre-Engineered Building solutions.
- > To deliver cost-effective and durable infrastructure that exceeds client expectations.
- > To lead the industry by embracing cutting-edge technology and sustainable practices.
- > To create smarter, energy-efficient and eco-friendly buildings for a better tomorrow.
- > To build long-term partnerships based on trust, quality and customer satisfaction.

OUR MISSION

"At **SOLUTECH INFRASTRUCTURE PVT. LTD.**, our mission is to revolutionize the construction industry with cutting-edge Pre-Engineered Building (PEB) solutions that are innovative, sustainable and cost-effective. We are committed to delivering high-quality structures with precision engineering, ensuring efficiency, durability and customer satisfaction. By leveraging advanced technology, eco-friendly practices, and a customer-centric approach, we aim to build strong, reliable and future-ready infrastructure that contributes to industrial and commercial growth. Our focus is on safety, timely project delivery and continuous improvement, making us the trusted partner for businesses worldwide."

Why Choose Solutech Infrastructure Pvt. Ltd. for PEB?

COST-EFFECTIVE & TIME-SAVING SOLUTIONS

Our PEB structures are designed for quick assembly, reducing construction time and labor costs while maintaining superior quality.

STRONG STRUCTURAL INTEGRITY & SAFETY

Our buildings are designed to withstand extreme weather conditions, seismic activity and heavy loads, ensuring maximum safety and performance.

EXPERIENCED & SKILLED TEAM

Our team of expert engineers, architects and project managers bring years of experience in delivering world-class PEB solutions.

TRUSTED BY LEADING BUSINESSES

We have a proven track record of successful projects across various industries, making us the preferred choice for businesses looking for high-performance PEB structures.

What is PEB (Pre-Engineered Building) ?

A **Pre-Engineered Building (PEB)** is a modern construction system where the entire structure is pre-designed, pre-fabricated, and assembled using steel components. Unlike conventional buildings, PEB are manufactured in a factory-controlled environment and then transported to the site for quick assembly, reducing construction time and cost.

ADVANTAGES

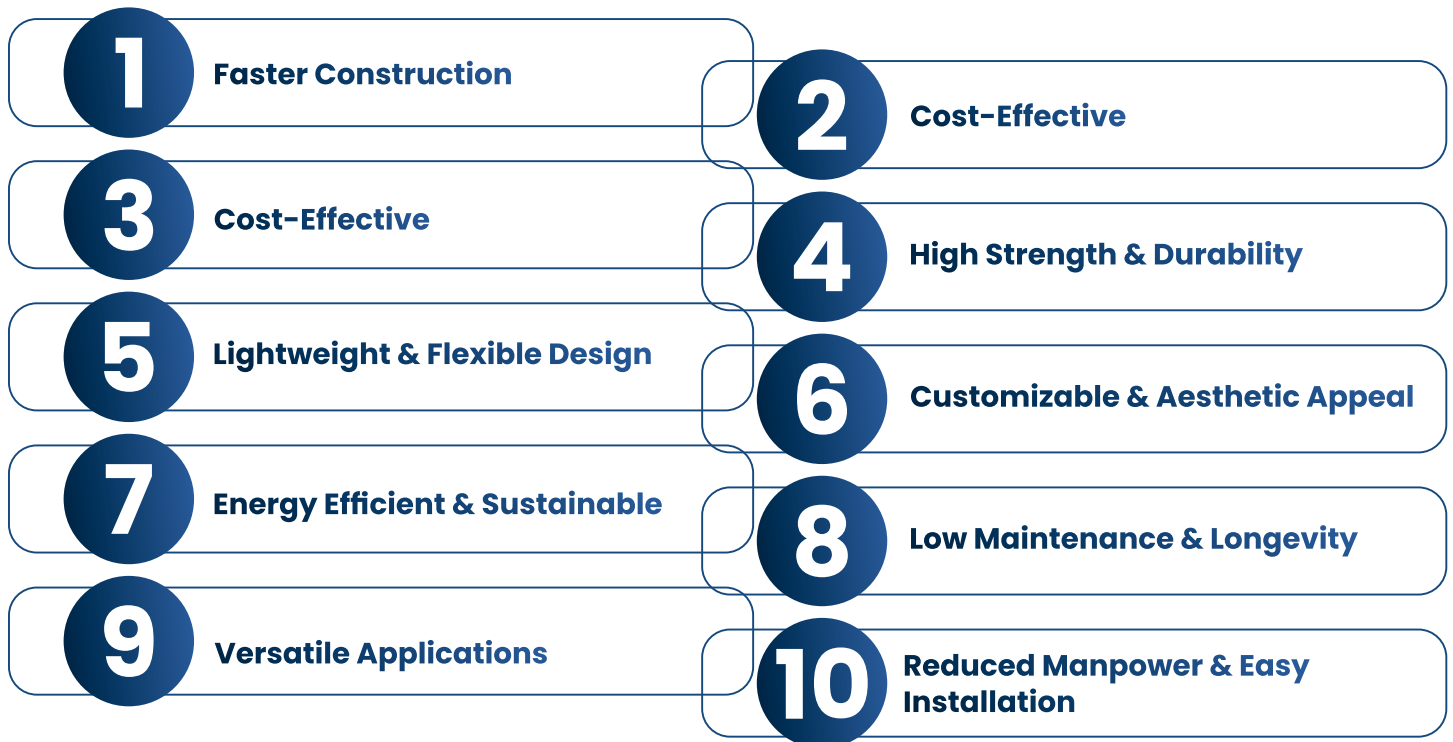

DOMAINS OF PEB

- > Industrial buildings
- > Warehouses
- > Office building
- > Showrooms
- > Railway stations / Metro station
- > Commercial centers
- > Recreational centers
- > Architectural buildings
- > Bridge girders
- > Godowns



HOW WE DO IT

SITE VISIT & PLAN



MANUFACTURING



PAINTING



INSTALLATION & ERECTION



**CUSTOMER
GA APPROVAL**



QUALITY CHECK



DESPATCH



HANDOVER

STRUCTURAL FRAMES

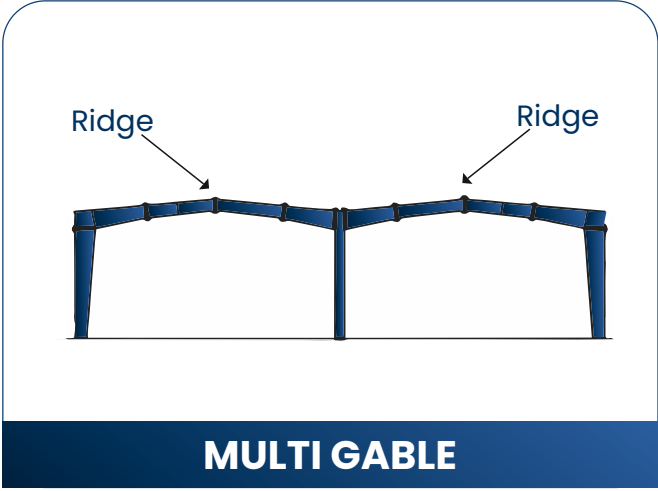
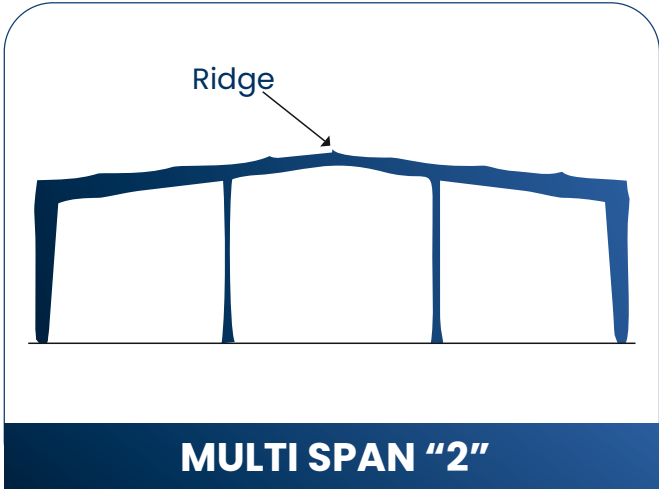
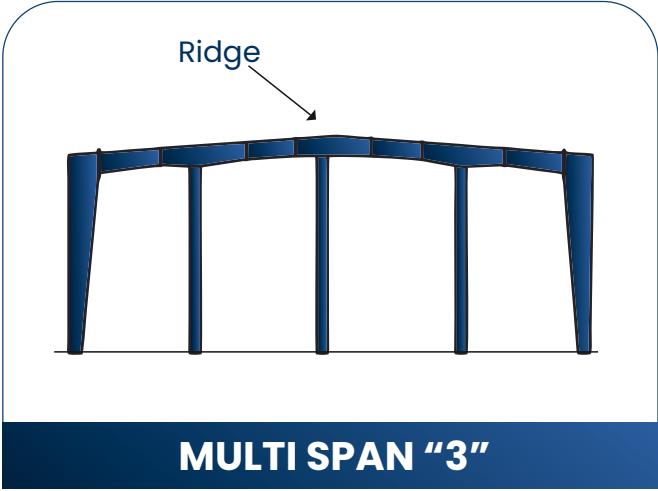
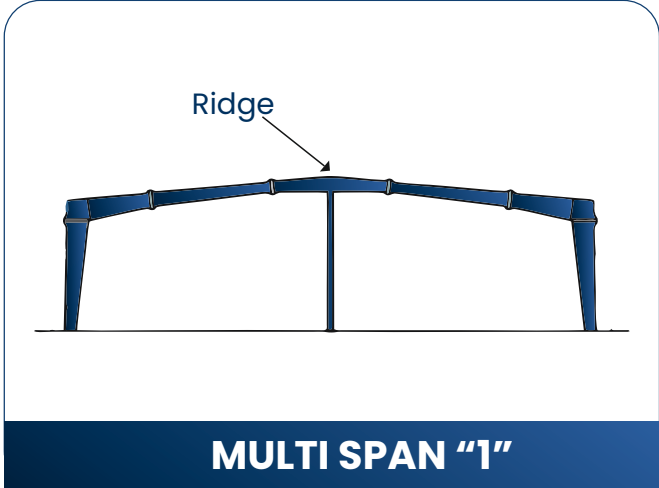
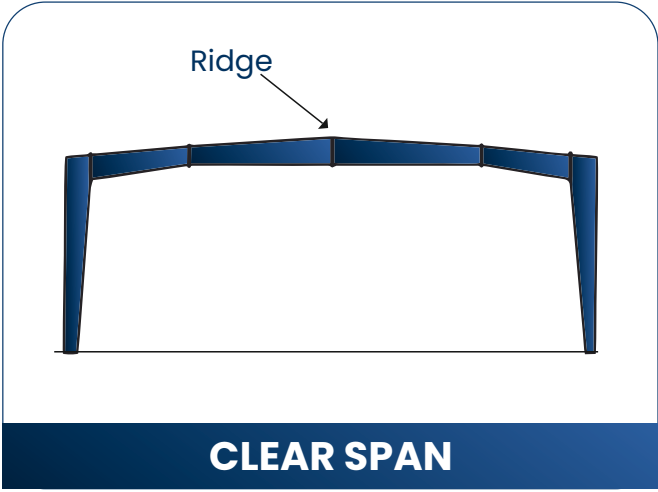

STRUCTURAL FRAMES

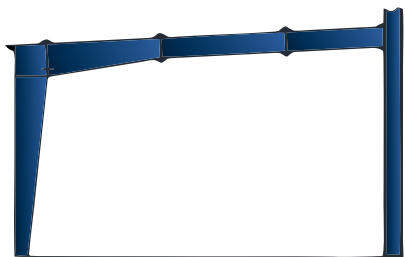

LEAN TO



NORTH LIGHT



MONO SLOPE

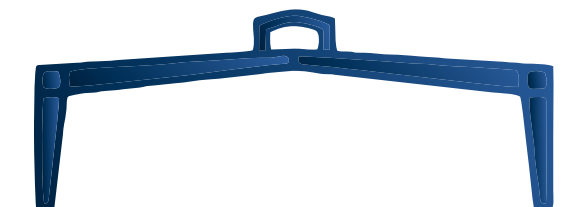

MONITOR TYPE

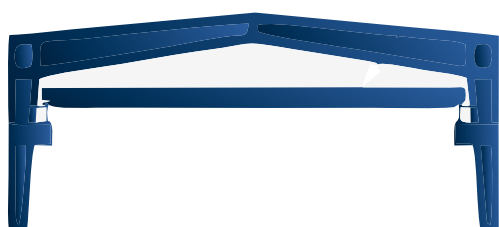

EOT CRANE



BUTTERFLY CANOPY

OUR MANUFACTURING FACILITY



**PULL THROUGH WELDING (PTW)
H BEAM" MACHINE**

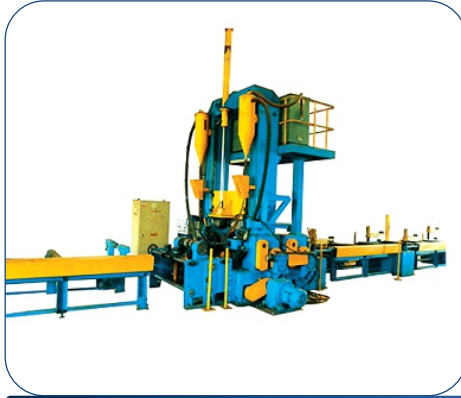

VERTICAL "I BEAM" MACHINE



CNC PLASMA CUTTING MACHINE



C -Z PURLIN MACHINE



CNC HYDRAULIC SHEARING MACHINE



ROLL FORMING MACHINE



RADIAL DRILL MACHINE



BAR THREADING MACHINE



HYDRAULIC POWER PRESS MACHINE



SAND BLASTING MACHINE



DECK SHEET ROLL FORMING MACHINE



DECK SHEET ROLL FORMING MACHINE

OUR MACHINE CAPACITY



PULL THROUGH WELDING (PTW) H BEAM" MACHINE

CAPACITY = 14Mtr. Length
2 Step Welding
1 Mtr. Width



C -Z PURLIN MACHINE

CAPACITY = C-Z Purling 20 Mtr. Length
C-Z 70 To 300 MM
Thickness = 1mm to 3.5 mm



CNC PLASMA CUTTING MACHINE

CAPACITY = 14 Mtr. Length
Cutting
Thickness= 3mm to 150 mm

OUR MACHINE CAPACITY



CNC HYDRAULIC SHEARING MACHINE

CAPACITY = 6500 MM Length
Cutting Length = 6200MM
Thickness = 4MM To 20 MM



HYDRAULIC POWER PRESS MACHINE

CAPACITY = 150 Ton



DECK SHEET ROLL FORMING MACHINE

CAPACITY = 50 Hp.

PRODUCT GALLERY



PEB ACCESSORIES & TRIMS

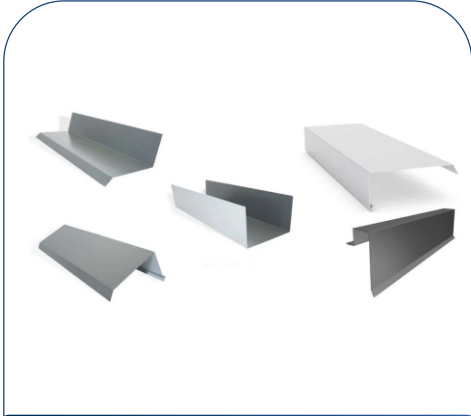

TRIMS

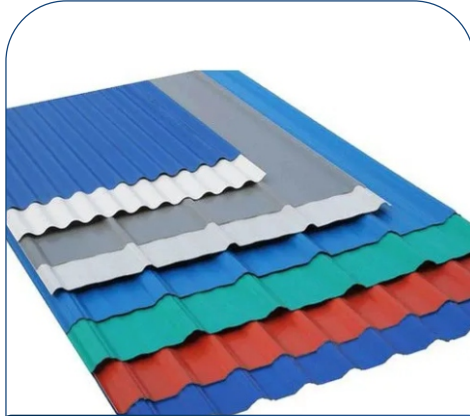

ROOFING SHEET



INDUSTRIAL LOUVERS



TURBO VENILATER



RIDGE VENTILATER



ROLLING SHUTTER

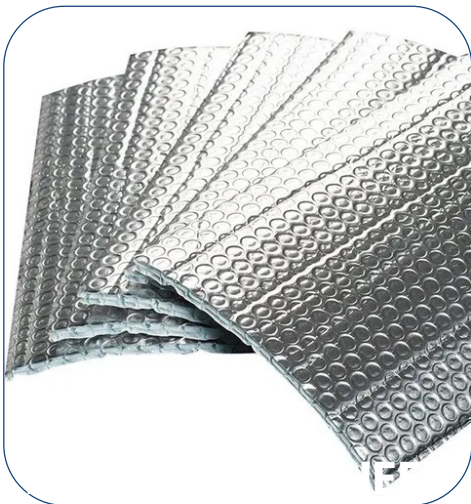

DECK SHEET

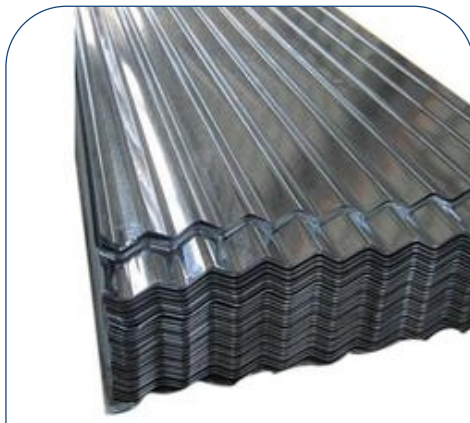

SKY LIGHT SHEET

- > ANCHOR BOLT
- > HIGH TENSILE NUT BOLT
- > METAL & FIBER DOWN SPOUT

- > ROCKWOOL INSULATION
- > SANDWICH PANEL
- > AND MANY MORE



Bharat Patel / Loveshik Patel
☎ 75750 71593 / 94267 85447



Survey No 876, 1 & 876/2, Kalavad Road, Opp. Subh-9,
Bhagvati Industrial Area, Anandpar, Gujrat 361162, India



www.solutechinfrastructures.com



info@solutechinfrastructures.com